

HOW TO PERFORM A BLOOD GLUCOSE TEST

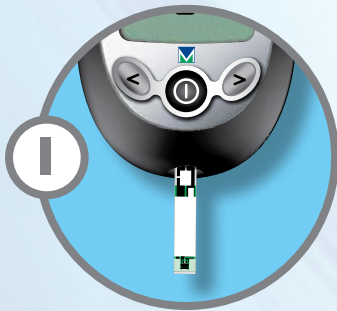

Insert an unused **GlucoMen[®] GM** test strip into the meter, black end first.



Obtain a blood sample – see overleaf.



Touch and hold the blood drop to the top edge of the test strip until the blood has been drawn into the test strip well.

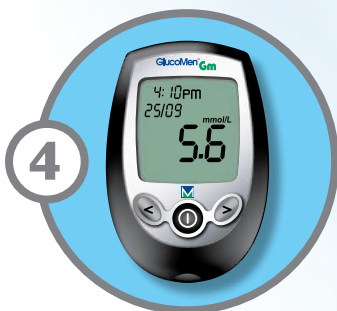
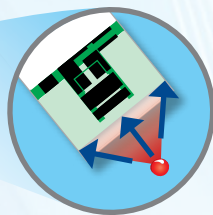

Your result is displayed in 7 seconds.

Glucoject[®] Dual S

HOW TO OBTAIN A BLOOD SAMPLE

Wash your hands with warm soapy water, rinse and dry thoroughly.

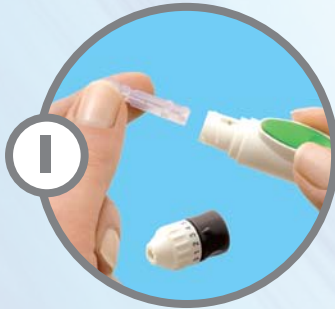

Insert a lancet

- Remove end cap
- Insert new lancet (Glucoject[®] No-dol) and remove protective cap
- Replace end cap



Adjust the depth setting

- Choose lowest possible setting
- 0 = minimum depth
- 6 = maximum depth
- Start at 0



Adjust the force setting

- Choose the lightest force setting first

Light

Medium

Strong



Prick your finger

- Prime the finger pricker by pulling back the end sleeve from the main body
- Hold the finger pricker firmly against the side of your finger tip
- Press the green release button

You can stimulate blood flow by hanging your hand downward, then massaging your palm and finger gently towards the tip.